

# Eaton 9130 Tower UPS



## Product snapshot

- Product rating:** 700–3000 VA
- Voltage** 120 Vac, 208–240V
- Frequency:** 50/60 Hz (auto-sensing)
- Configuration:** Tower

Advanced power protection for:

- IT and networking environments
- Servers, networking gear
- Telecommunications, VoIP, security systems
- Medical systems
- Diagnostics and medical screening
- Patient record archives
- Manufacturing systems
- Chip fabrication
- Pharmaceutical production
- Chemical processing

## Features

- Protects against downtime, data loss and process interruption by providing continuous, clean power
- Offers premium performance with a 0.9 power factor and >95 percent efficiency in high efficiency mode
- Increases battery service life and system uptime with ABM® battery charging technology
- Enables prolonged runtime of essential equipment during power outages by allowing for orderly, remote shutdown of non-critical systems or processes
- Conserves valuable space with a slim tower design
- Ensures data and system integrity with Intelligent Power® Manager supervisory software, which provides easy, versatile, remote monitoring and management of multiple devices
- Provides a two-year limited warranty, an extended warranty, on-site Flex and on-site PowerTrust service contracts, and a \$250,000 load protection guarantee (U.S. and Canada)

## Maximum availability

- ABM technology increases battery life and system uptime
- Load segments allow for selective load shedding during outages
- Optional hot-swappable extended battery modules (EBMs) extend backup run-time for hours
- Internal hot-swappable batteries can be replaced without powering down the UPS
- UPS startup on battery power
- Optional HotSwap Maintenance Bypass (MBP) enables the entire UPS to be serviced or replaced without interrupting power to loads

## Low total cost of ownership

- More real output power for dollar spent with 0.9 power factor
- Cuts energy usage and costs with >95% efficiency rating in high efficiency mode



Powering Business Worldwide





Bright LCD user interface



Add up to four EBMs for hours of runtime



Optional FlexPDU and HotSwap MBP for greater flexibility and uptime

## UPS status and operation

- Bright, front panel LCD for easy monitoring and management
- LEDs to show system status
- Optional FlexPDU adds more plug-and-play flexibility, streamlining power distribution
- Multiple options for industry-standard communications
- Intelligent Power Manager supervisory software included free of charge
- Free NetWatch 5.0 software enables automatic shutdown of UPS-protected devices, including virtualized servers
- Direct monitoring via existing management systems and LANs

## Communications

- A standard communication slot accepts interfaces for Web, SNMP, Modbus or serial connectivity
- Connect directly to the Ethernet network and the Internet to monitor and manage the UPS with a standard Web browser
- Monitor power conditions in real time through existing facilities or building management system
- Monitor and gracefully shut down multiple servers running various operating systems
- Receive alarm notifications from the UPS, environmental monitoring devices or security systems



Eaton NetWatch Client 5.0 has tested compatible with Cisco Unified Communications Manager 4.3.

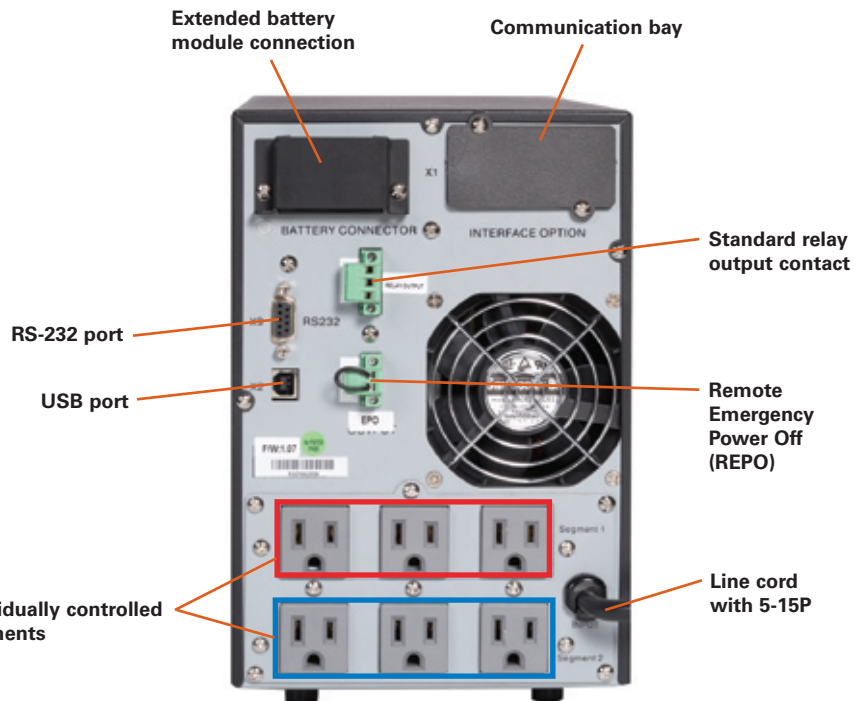

UPS rear panel (PW9130L1500T-XL)

## Battery runtimes (in minutes)

Load (VA/Watts)	Internal batteries	w/1 EBM	w/2 EBMs	w/3 EBMs	w/4 EBMs	Load (VA/Watts)	Internal batteries	w/1 EBM	w/2 EBMs	w/3 EBMs	w/4 EBMs
<b>PW9130L700T</b>						<b>PW9130i1500T-XL</b>					
700/490	8	N/A	N/A	N/A	N/A	1500/1050	7	32	61	98	128
525/368	12	N/A	N/A	N/A	N/A	1125/788	11	47	83	126	195
350/245	21	N/A	N/A	N/A	N/A	750/525	18	81	143	208	262
175/123	37	N/A	N/A	N/A	N/A	375/263	38	171	298	416	564
<b>PW9130i700T</b>						<b>PW9130L2000T-XL</b>					
700/490	8	N/A	N/A	N/A	N/A	2000/1400	15	61	111	156	194
525/368	12	N/A	N/A	N/A	N/A	1500/1050	21	81	145	184	269
350/245	19	N/A	N/A	N/A	N/A	1000/700	34	129	198	293	410
175/123	35	N/A	N/A	N/A	N/A	500/350	72	225	449	590	766
<b>PW9130L1000T-XL</b>						<b>PW9130G2000T-XL / XLEU / PW9130i2000T-XL</b>					
1000/700	10	40	73	108	149	2000/1400	15	61	111	156	186
750/525	13	58	101	152	219	1500/1050	21	81	145	184	248
500/350	24	85	172	249	304	1000/700	34	129	198	293	431
250/175	48	190	310	451	569	500/350	72	225	449	590	840
<b>PW9130G1000T-XL / XLEU / PW9130i1000T-XL</b>						<b>PW9130L3000T-XL</b>					
1000/700	10	40	78	110	150	3000/2100	9	35	66	95	132
750/525	13	55	103	151	223	2250/1575	13	53	100	139	183
500/350	22	82	186	250	312	1500/1050	22	86	153	221	267
250/175	47	190	328	431	584	750/525	69	168	298	395	545
<b>PW9130L1500T-XL</b>						<b>PW9130G3000T-XL / XLEU / PW9130i3000T-XL</b>					
1500/1050	7	34	63	88	135	3000/2100	9	36	68	101	137
1125/788	11	44	84	129	210	2250/1575	12	49	90	134	165
750/525	18	79	148	207	267	1500/1050	20	79	143	180	240
375/263	38	167	278	475	540	750/525	46	161	267	434	547

### Notes:

Backup times are approximate and may vary with equipment, configuration, battery age, temperature, etc.  
Runtimes are shown at a 0.7 power factor.

## 9130 models

Catalog number	Style number	Rating (VA/Watts)	Input connection <sup>1</sup>	Output receptacles	Dimensions H x W x D, in (mm)	Weight, lb (kg)
<b>North American models: 120V, 50/60 Hz</b>						
PW9130L700T	103006426-6591	700/630	5-15P	(6) 5-15R	9.1 x 6.3 x 13.8 (230 x 160 x 350)	26.9 (12.2)
PW9130L1000T-XL	103006427-6591	1000/900	5-15P	(6) 5-15R	9.1 x 6.3 x 15.0 (230 x 160 x 380)	32.0 (14.5)
PW9130L1500T-XL	103006428-6591	1500/1350	5-15P	(6) 5-15R	9.1 x 6.3 x 16.9 (230 x 160 x 430)	41.9 (19.0)
PW9130L2000T-XL	103006429-6591	2000/1800	5-20P	(1) L5-20R, (4) 5-20R	12.8 x 8.4 x 16.1 (325 x 214 x 410)	76.1 (34.5)
PW9130L3000T-XL	103006430-6591	3000/2700	L5-30P	(4) 5-20R, (1) L5-30R	12.8 x 8.4 x 16.1 (325 x 214 x 410)	76.1 (34.5)
<b>Global models: 208V, 50/60 Hz</b>						
PW9130G1000T-XL	103006431-6591	1000/900	L6-20P <sup>2</sup>	(1) L6-20R, (2) 6-20R	9.1 x 6.3 x 15.0 (230 x 160 x 380)	32.0 (14.5)
PW9130G2000T-XL	103006432-6591	2000/1800	L6-20P <sup>2</sup>	(1) L6-20R, (4) 6-20R	12.8 x 8.4 x 16.1 (325 x 214 x 410)	76.1 (34.5)
PW9130G3000T-XL	103006446-6591	3000/2700	L6-20P <sup>3</sup>	(1) L6-30R, (1) L6-20R, (2) 6-20R	12.8 x 8.4 x 16.1 (325 x 214 x 410)	76.1 (34.5)
PW9130G1000T-XLEU	103006477-6591	1000/900	L6-20P <sup>2</sup>	(6) C13	9.1 x 6.3 x 15.0 (230 x 160 x 380)	32.0 (14.5)
PW9130G2000T-XLEU	103006478-6591	2000/1800	L6-20P <sup>2</sup>	(8) C13, (1) C19	12.8 x 8.4 x 16.1 (325 x 214 x 410)	76.1 (34.5)
PW9130G3000T-XLEU	103006479-6591	3000/2700	L6-20P <sup>3</sup>	(8) C13, (1) C19	12.8 x 8.4 x 16.1 (325 x 214 x 410)	76.1 (34.5)
<b>International models: 230V, 50/60 Hz</b>						
PW9130i700T	103006433-6591	700/630	C14	(6) C13	9.1 x 6.3 x 13.8 (230 x 160 x 350)	26.9 (12.2)
PW9130i1000T-XL	103006434-6591	1000/900	C14	(6) C13	9.1 x 6.3 x 15.0 (230 x 160 x 380)	32.0 (14.5)
PW9130i1500T-XL	103006435-6591	1500/1350	C14	(6) C13	9.1 x 6.3 x 16.9 (230 x 160 x 430)	41.9 (19.0)
PW9130i2000T-XL	103006436-6591	2000/1800	C14	(8) C13, (1) C19	12.8 x 8.4 x 16.1 (325 x 214 x 410)	76.1 (34.5)
PW9130i3000T-XL	103006437-6591	3000/2700	C20	(8) C13, (1) C19	12.8 x 8.4 x 16.1 (325 x 214 x 410)	76.1 (34.5)
<b>Extended battery modules</b>						
PW9130N1000T-EBM <sup>4</sup>	103006438-6591	NA	NA	NA	9.1 x 6.3 x 15.0 (230 x 160 x 380)	40.8 (18.5)
PW9130N1500T-EBM <sup>5</sup>	103006439-6591	NA	NA	NA	9.1 x 6.3 x 16.9 (230 x 160 x 430)	53.6 (24.3)
PW9130N3000T-EBM <sup>6</sup>	103006440-6591	NA	NA	NA	12.8 x 8.4 x 16.1 (325 x 214 x 410)	110.3 (50.0)

<sup>1</sup> Input cord length is 6 ft

<sup>2</sup> C14, w/detachable L6-20P

<sup>3</sup> C20, w/detachable L6-20P

<sup>4</sup> This EBM works with 1000 VA model, where available

<sup>5</sup> This EBM works with 1500 VA model

<sup>6</sup> This EBM works with 2000/3000 VA models, where available

### Additional notes:

When high voltage 9130 is used at 208V, derate power by 10% and 20% at 200V  
When low voltage 9130 is used at 110V, derate power by 10% and 20% at 100V

### Comprehensive Eaton services available for 9130 Tower products

- Warranty+ extended warranties—3 or 5 years total
- On-site service plans for startups and preventive and corrective maintenance

